

# DIADEM-150

OUTLET EDGE / KSA SCUPPER INSPECTION BOX KLS

#901300\_A150\_01



## Detail Drawing

■ Green up the roof!

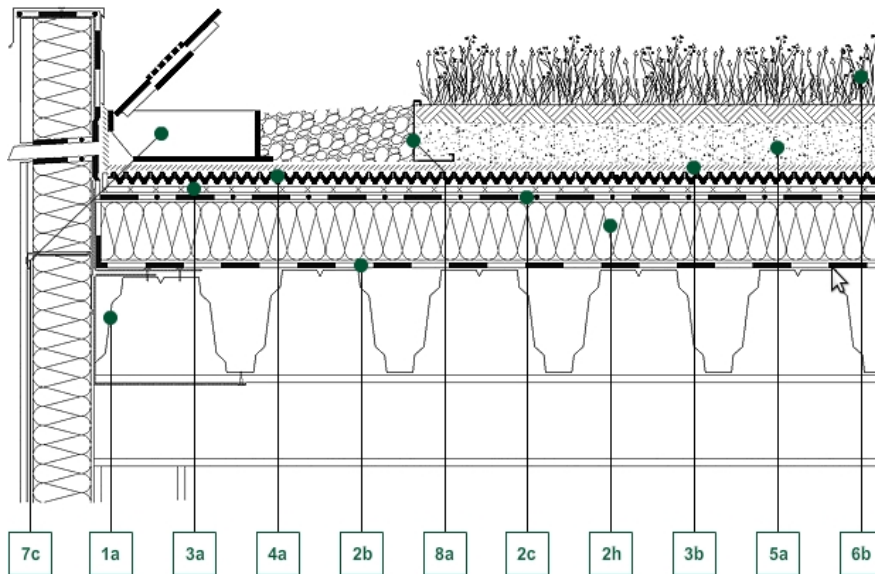

### Decking constructions:

1a - Steel trapezoid sheet structure

### Water isolation:

2b - FLW-400 ext. Root protection

2c - Waterproof membrane

2h - Thermal insulation

### Geotextile layers:

3a - VLU-300 mechanical protecting layer

3b - VLF-150 filter layer

### Drainboards:

4a - DD-25H drainage board

### Growth medias:

5a - SEM-12 extensive growth medium

### Vegetation:

6a - Drought-resistant perennials

### Hydrotechnical products:

7c - KSA-10 scupper boxes 4"

### Edging element:

8a - KLS-AL-8/12 Gravel Board

### Description of section:

It is recommended, that each roof area has a minimum of two drainage outlets. Local conditions determine where these are located and may also indicate an additional requirement for the installation of an overflow. It is important that these drainage points remain free from any obstruction, therefore access should be provided for maintenance purposes.

DIADEM USA, Inc.

8795 SW Tualatin Sherwood Rd #1005, Tualatin, OR 97062  
E-mail: [info@diademusa.com](mailto:info@diademusa.com), Web: [www.diademusa.com](http://www.diademusa.com)