

# KSR+10

Extension element for KSR inspection boxes. Height: 4"

100202

## KEY FEATURES

- Can be used on all types of intensive green roofs regardless of pavers or vegetation placed around the roofoutlet
- Stacking almost limitless
- The lid is lockable to the extension ring too
- Compatible with the KSR+5 extension ring

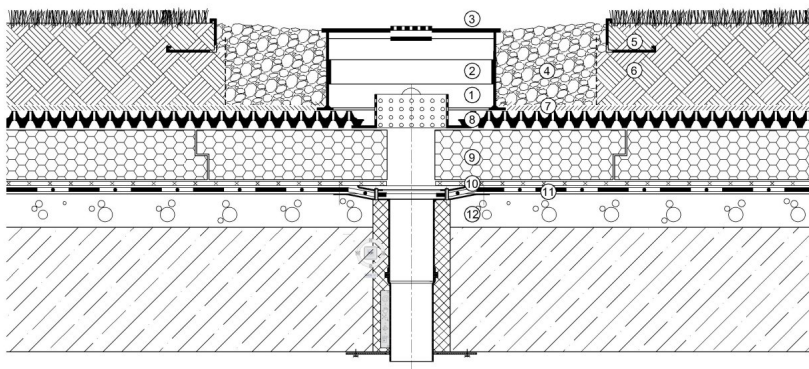

(1)KSR-10 inspection box, (2)KSR+10 extension element, (3)KSR cover, (4)Gravel, (5)KLS gravel board, (6)SIM growing media, (7)VLF filter geotextile, (8)DiaDrain-40 drainage and reservoir board, (9)Thermal insulation, (10)VLU mechanical protection layer, (11)root resistant waterproofing membrane, (12)roof construction

## APPLICATION

With the aid of the height extension elements KSR+5 and KSR+10 (2" and 4" in height, respectively), it is easy to modify the height of the KSR-10 boxes to meet the required substrate depth.

## SPECIFICATION

KSR+10 height extension rings, made out of composite materials for KSR-10 maintenance boxes. Diameter 15-3/4"x4", weight 1.76 lbs.



## TECHNICAL DATA

Height: (inch)	4.0
Diameter: (inch)	15-3/4
Weight: (lbs)	1.76
Color:	RAL 7032
Material:	Polypropylene
Material Requirement: (pc/pc)	1.05
Installation Standard: (hr/piece)	0.80

Reviewed: 2017-02-02 14:18:30



DIADEM USA, Inc.  
8795 SW Tualatin Sherwood Rd #1005, Tualatin, OR 97062  
info@diademusa.com • www.diademusa.com



Green Up the Roof!