

DE-25

Drainage Composite, consist of a dimpled perforated core

1646282974

KEY FEATURES

- High storm water retention and storage capacity, 0.29 gal/sqf
- "Stepped barrier" design slows run-off velocity, reducing pressure on storm water infrastructure
- Recessed evaporation vents improve ventilation under the system
- Helps distribute the water from the drip irrigation system
- Increased contact area lowers overall surface pressure

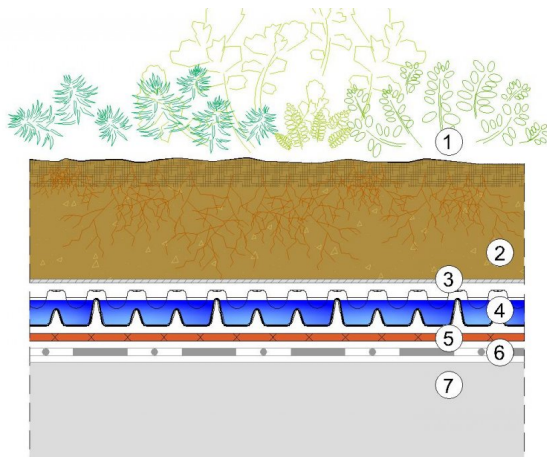

(1)Vegetation, (2)Growing media, (3)VLF 150/200 filter layer, (4)DiaDrain-25H, (5)VLU 300/500 mechanical protection layer, (6)Root resistant waterproofing membrane, (7)Roof construction

APPLICATION

DiaDrain-25H is designed for continuous drainage of flat- and low slope roofs, including vegetated areas and hard-surface pedestrian areas of extensive and semi-intensive vegetative roofs. The "stepped barrier" design of DD-25H causes the retention cups to fill with water in a similar fashion to filling an ice cube tray, enabling their flow-delay and retention functions. DD-25H boards are lain overlapping one row of cups with the adjacent board, starting at the bottom of the roof slope and moving upward.

SPECIFICATION

DD-25H, one inch height flow-delay retention board composed of recycled high-impact polystyrene. Stepped barrier design with deep-drawn recessed evaporation vents and water channel system on the underside. Compressive strength: 6725 lbf/sqft (unfilled), drainage capacity at 2% roof slope: 0.15 gal/ft/sec; certified according to EN ISO 12958, water storage capacity: 0.29 gal/sqf, microbiological resistance tested (EN 12225), fire resistance classification "Broof(t2)"(EN 13501-5). Weight per unit Area: 40.11 oz/sqf; Board size 6 7-1/2" x 3 7-1/4" x 1" (LxWxH); Packaging: 5973 sqft/pallet.



TECHNICAL DATA

In-fill Volume: (gal/sqft)	0.345
Board Area: (sqft)	23.917
Water retention capacity: (gal/sqft)	0.302
Packaging unit: (pieces/Pal)	250
Board Length: (inch)	6 7-1/2"
Installation standard: (hr/sqft)	0.015
Flammable classification:	Broof(t2)
Material Requirement: (sqft/sqft)	1.01
Packaging unit: (sqft/Pal)	5,973
Color:	black
Material:	recycled high-impact polystyrene (HIPS)

Reviewed: 2022-03-02 23:49:34



DIADEM USA, Inc.
8795 SW Tualatin Sherwood Rd #1005, Tualatin, OR 97062
info@diademusa.com • www.diademusa.com



Green Up the Roof!