

VLF-150

320201

Nonwoven, needlepunched geotextile for separation and filtration functions.

KEY FEATURES

- Resistant to both acidic and basic substances and environments.
- Withstands heavy point loading.
- Excellent permeability.
- Easy to cut.

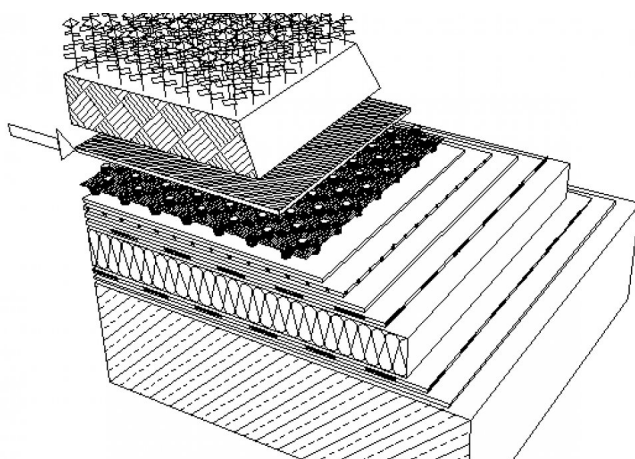

APPLICATION

VLF-150 fabrics have many uses on vegetated roofs, but their main functions are filtering run off, mechanical protection, and separation of incompatible materials. VLF-150 geotextiles provide excellent filtration performance without becoming clogged.

SPECIFICATION

Diadem VLF-150 is a needle-punched fleece, non-woven polypropylene geotextile used to filter run-off and keep sediments and fine particles from washing out. The geotextile is resistant to bitumen and biological and chemical environments typically found in soils, and has limited resistance to UV degradation. Install on top of drainage layer, root barrier layer or on root resistant waterproofing. End laps should be 12 inch, and side laps 4 inch.

TECHNICAL DATA

| | |
|---------------------------------|---------------------|
| Tensile strength: (lbs) | 115 |
| Water flow rate: (gpm/sqf) | 140 |
| Apparent opening size: (AOS^3) | 70 US Std (0.212mm) |
| Roll width: (ft) | 6-1/4 |
| Roll length: (ft) | 360 |
| Roll area: (sqf) | 2,250 |
| Weight: (oz/sy) | 4.0 |
| Material requirement: (sqf/sqf) | 1,15 |
| Installation standard: (hr/sqf) | 0,007 |
| Robustness class: (GRK) | 3 |

Reviewed: 2015-07-03 11:31:26



DIADEM USA, Inc.
721 NW Ninth Avenue, Suite 400, Portland, OR-97209
info@diademusa.com • www.diademusa.com



Green Up the Roof!