

DIADEM-350

WALL TERRACE / GARDIA GUARDRAIL RNH

#901307_B350_01



Detail Drawing

■ Green up the roof!

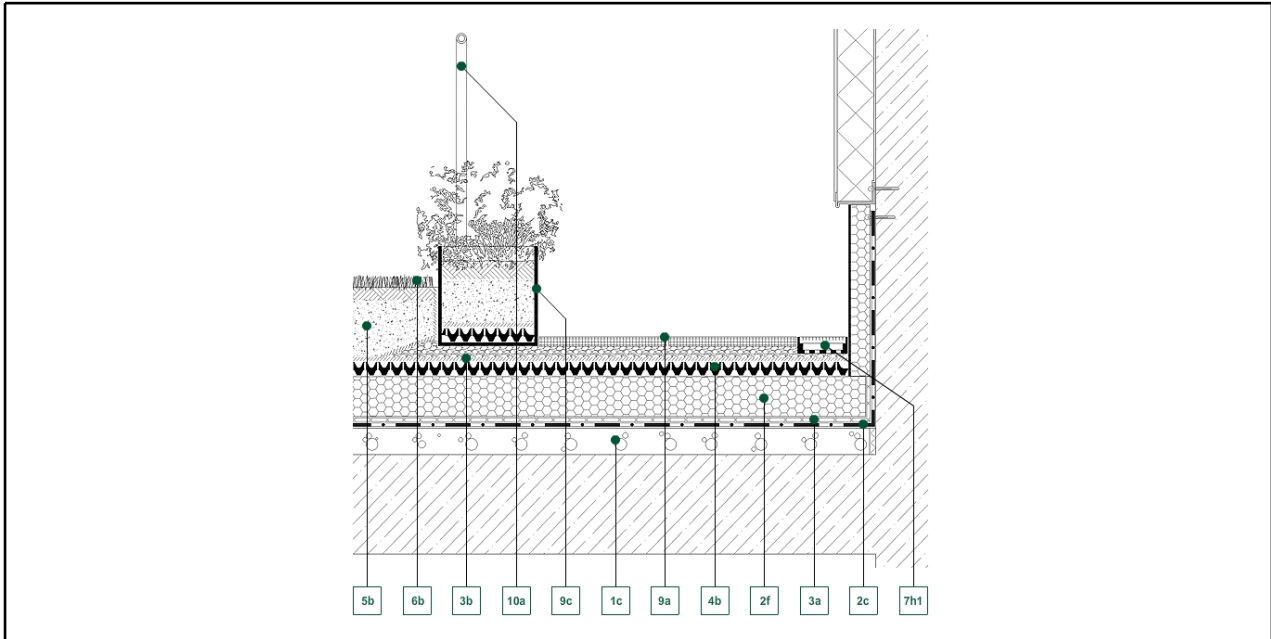

Decking constructions:

- 1b - Reinforced concrete structure
- 1c - Slope-forming layer

Water isolation:

- 2c - Waterproof membrane
- 2f - Extruded PS-foam thermal insulation

Geotextile layers:

- 3a - VLU-300 mechanical protecting layer
- 3b - VLF-150 filter layer

Drainboards:

- 4b - DD-40H Retention Board

Growth medias:

- 5b - SIM-30 extensive growth medium

Vegetation:

- 6b - Perennials, lawn

Hydrotechnical products:

- 7h1 - RNH-8/12 Roof Channel

Terraces accessories:

- 9a - FK-5 Slab spacer
- 9c - PGE-110 fPlant containers

Safety technology:

- 10a - DRS-Light Handrail Structure

Description of section:

Rainwater running down the facade can often be as much as that accumulating from the horizontal roof surface. It is therefore crucial that at the junction of these planes water is prevented from flooding into the building. The RNF Drainage Channel delivers a perfect solution here. Paving slabs should be laid with open joints and kept permanently separated by the use of FK Paving Spacers. The DRS Planter Railing System is a practical, yet aesthetically pleasing means of providing protection and creating demarcated areas.

DIADEM USA, Inc.

8795 SW Tualatin Sherwood Rd #1005, Tualatin, OR 97062
E-mail: info@diademusa.com, Web: www.diademusa.com