

FLG-Line-30.1-C line system

Self-Ballasted, Dynamic Fall Arrest system for roofs up to a 5% slope.

130096

KEY FEATURES

- Invisible design
- Simple installation
- No need to break through roof insulation
- No "heat bridge" developing
- Integrated with lightning conductor system

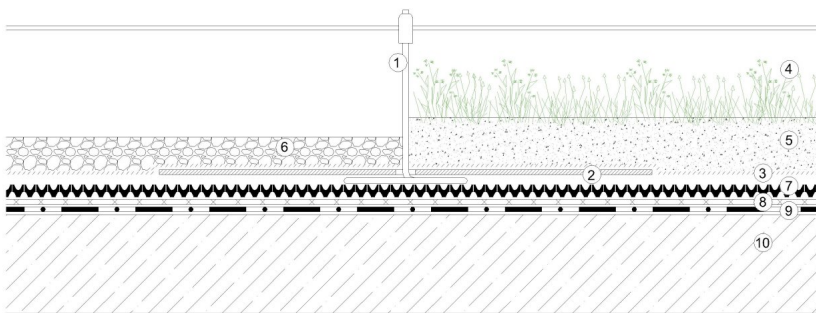

(1)FLG 30.1-C anchoring point, (2)Damping plate, (3)FGT-180 damping mat, (4)Vegetation, (5)Growing media, (6)Gravel, (7)DiaDrain-25H flow-delay retention board, (8)VLU-300/500 mechanical protection layer, (9)Roof resistant waterproofing membrane, (10)Roof construction

SPECIFICATION

The Diadem FLG-System is an anchoring device which ensure the safety of staff working at heights. It has been tested by TRI-Environmental, a pre-eminent testing laboratory in the United States, to show product conformance with ANSI/ASSE Z359.1. The FLG self-ballasted safety system is certified against fall, due standard EN 795:1996 class C , as fall arrest or fall restraint system, installed without penetrating the waterproof membrane, with stainless steel cable (3/8") parallel with the parapet wall, incl. all accessories made of 1.4404 (316) stainless steel, with composite damping plate, and pulling mat. The system requires a minimum of 16-3/8 lbs/sf ballast material, which is NOT part of system. Supplied as fully-functional system ready for immediate professional installation according to the approved implementation plan.

TECHNICAL DATA

Number of workers at one time:	1
Post diameter: (inch)	1/2"
Anchor post material:	Stainless steel
Cable diameter: (inch)	6/16"
Safety cable material:	Stainless steel
Thickness of Plate: (inch)	3/8"
Damping plate material:	Recycled composite
Mat waterpermeability: (lxm ² xs)	105
Tensile strength weft: (kp / ft)	477
Tensile strength warp: (kp / ft)	477
Locking Head Diameter: (inch)	1"

Reviewed: 2012-11-04 21:33:34



APPLICATION

The Diadem FLG Dynamic Fall Arrest System represents the first introduction of this class of dynamic fall arrest systems in the United States. This methodology has been proven over years of experience in Europe and offers a practical means of achieving a safe operating environment for green roof maintenance workers when used as directed. The advantages of this system include the fact that it does not require any attachments to the structural deck or waterproofing. It relies entirely on the dry dead weight of the green roof and friction stresses to resist a fall, consequently it could be used on every roof decks where the load bearing capacity is present, but no solid structures are available around .



DIADEM USA, Inc.
8795 SW Tualatin Sherwood Rd #1005, Tualatin, OR 97062
info@diademusa.com • www.diademusa.com

Green Up the Roof!

