

TGS-40

Outlet inspection box with cast iron lid for public areas

140328

KEY FEATURES

- Vandalism resistant
- Safe for vehicle traffic
- Fits flexibly to local height conditions

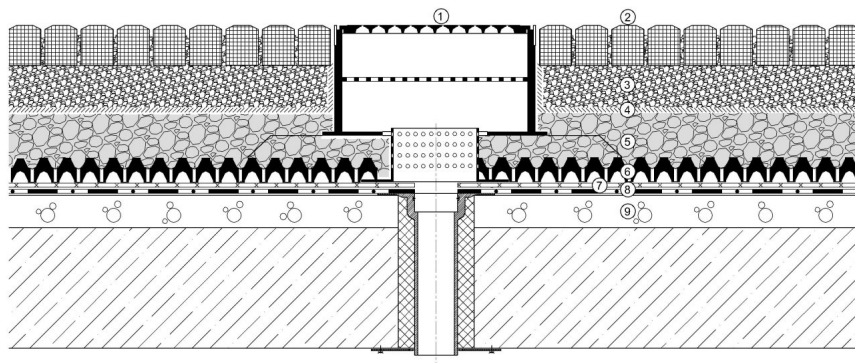

- (1) TGS inspection box, (2) paved area, (3) Bedding, (4) VLF filter geotextile, (5) supporting layer, (6) DiaDrain-60 drainage board, (7) VLU mechanical protection layer, (8) Root resistant waterproofing membrane, (9) Roof construction

APPLICATION

TGS inspection box is especially recommended for public areas, locations with high regularity of light vehicle traffic and also in locations susceptible to damage. It is used to ensure unobstructed water drainage as well as professional maintenance of the water outlets. TGS also protects the outlets from severe external effects. TGS products can be used on both public places and places where there are a heavy traffic of personal vehicles.

SPECIFICATION

TGS boxes for intensive green roofs with a minimum of 10" build-up depth to ensure water drainage both in the drainage layer, and on the surface as well. The removeable lid ease the maintenance of the water outlets, and yet protects the outlets from severe external effects. TGS products can be used on both public places and places where there are a heavy traffic of personal vehicles.



TECHNICAL DATA

| | |
|--|---------------------------------------|
| Height : (inch) | 12 (in custom heights also available) |
| Width: (inch) | 15-3/4 |
| Length: (inch) | 15-3/4 |
| Weight: (lb) | 50 |
| Drainage openings: (inch) | 1/4 x 7 7/8 |
| Outlet surface area: (sq in) | 11 5/32 |
| Drain pipe connection with clamp, d=52 mm: (pcs) | 4 |
| Material (Base): | Polypropylene |
| Material (lid): | Cast iron |
| Color (housing): | RAL 7032 |
| Color (lid): | brown |

Reviewed: 2015-02-23 14:46:00



DIADEM USA, Inc.
8795 SW Tualatin Sherwood Rd #1005, Tualatin, OR 97062
info@diademusa.com • www.diademusa.com



Green Up the Roof!