

# RDL-120

Recycled composite edging products

160250

## KEY FEATURES

- Enviromental friendly materials
- The roof structure underneath remains intact
- Multiple coating options
- No site concreting no rebars needed
- Quick installation
- Long-lasting

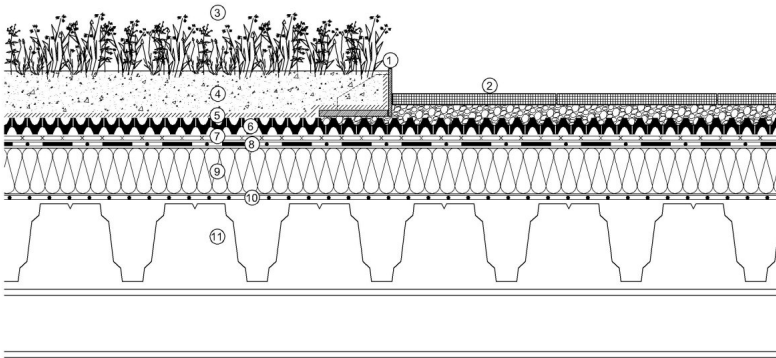

(1)RDL edge kerb (2)Concrete slab, (3)Vegetation, (4)SIM Growing media, (5)VLF filter geotextile, (6)DiaDrain-40 drainage board,(7)VLU mechanical protection layer,(8)Root resistant waterproofing membrane, (9)Thermal insulation, (10)FLW-400 vapour control layer, (11)Roof construction

## APPLICATION

Wide range of RD edge kerbs could be used as the edging of terraces and green roofs, or separating different areas giving a special design to the roof landscape. They are important distinctive pieces in the development of a garden layout. The product is made in four feet long modules. The front panel could get different finishes such as paintings or coatings, but many designer and owner selects the nature appearance of the product.

## SPECIFICATION

RDL - "L" shaped products are made of recycling composit materials for edging or landscaping light-weight green roofs. A resin based plaster coating is an option, which gives a pearlescent appearance. Also available in a choice of RAL colors.



## TECHNICAL DATA

Height: (inch)	4 ¾
Width: (inch)	7 ½
Length: (inch)	45 ¼
Thickness of front panel: (inch)	3/16
Material (front panel):	rice husk-plastic-composite
Material (base plate):	recycled polyethylene
Color:	brown
Surface finish (optional):	painted or coated

Reviewed: 2015-07-22 11:31:16



DIADEM USA, Inc.  
8795 SW Tualatin Sherwood Rd #1005, Tualatin, OR 97062  
info@diademusa.com • www.diademusa.com



Green Up the Roof!