

RDA-425

Lightweight edge unit for intensive gardens

160325

KEY FEATURES

- Low structural weight
- Different colors available
- Can illuminate
- Long-lasting
- Includes conduits for electrical wires
- Quickly assembled
- Special sizes available

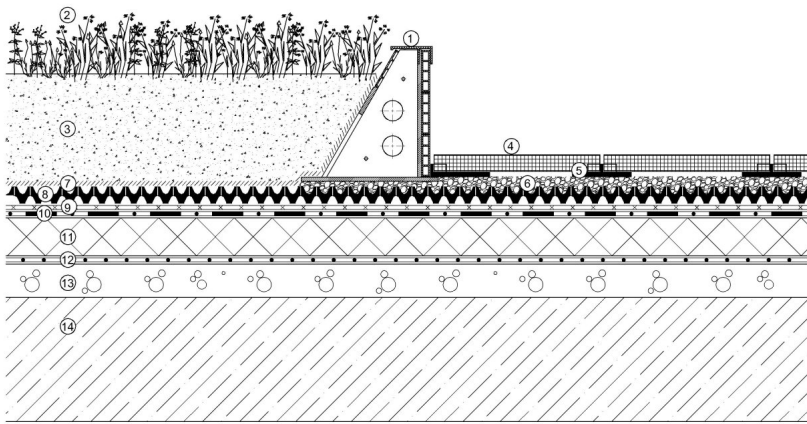

(1)RDA-425 edge kerb (2)Vegetation, (3)SIM Growing media, (4)Concrete slab, (5)FKU-5 cross spacer, (6)VLF filter geotextile,(7)DiaDrain-40 drainage board,(8)VLU mechanical protection layer, (9)Root resistant waterproofing membrane, (10)Thermal insulation, (11)FLW-400 vapour control layer, (12)Roof construction

APPLICATION

RDA edge kerbs are to separate vegetated and paved areas, and edging max. 16" high layers of intensive green roofs. At the same time, these units can be used to house trunking for electrical wires and irrigation pipes. Due to their light weight RDA edge kerbs are applicable on roof structures with lower load bearing capacity.

SPECIFICATION

RDA products are a lightweight, design solution for separating different garden areas. The product is made out of recycled composite panels and includes conduits for irrigation hoses and/or electrical wire. Stainless steel coupling screws are included. Size(LxWxH): 45 1/4x18 1/8x16 6/8 inches; Weight: 11.7 lb/ft.

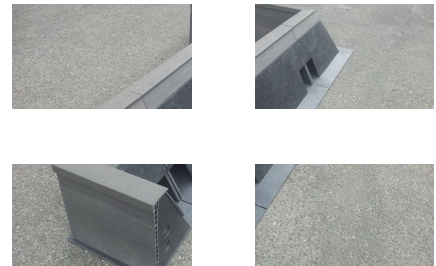

TECHNICAL DATA

Height: (in)	16 6/8
Length: (in)	45-1/4"
Width: (in)	18 1/8
Weight: (lb/ft)	11.7
Material:	Recycled composite
Color:	dark grey
Packaging unit: (piece/Pal.)	12
Material requirement: (piece/lm)	1,05
Coverage rate: (h/lm)	0,40
Accessories:	Corner pieces

Reviewed: 2014-06-25 13:49:24



DIADEM USA, Inc.
8795 SW Tualatin Sherwood Rd #1005, Tualatin, OR 97062
info@diademusa.com • www.diademusa.com



Green Up the Roof!