

KLS-AL-4520

Structural Metal Edge

162061U6

KEY FEATURES

- Swift and straightforward installation
- Effortless creation of corner angles or custom lengths
- Custom sizes and colors available upon request
- Does not obstruct water drainage

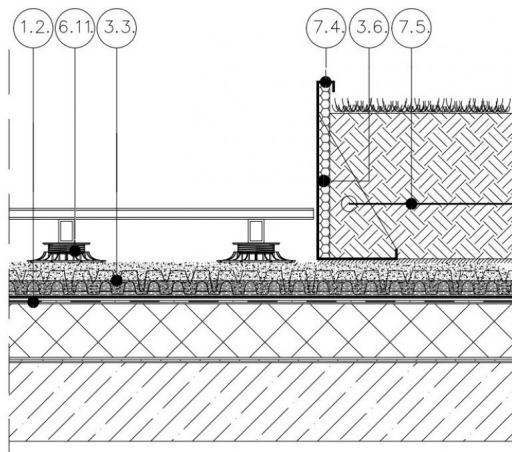

(1.2)Root resistant waterproofing membrane, (6.11)Adjustable Pedestals, (3.3) DiaDrain-60 drainage and retention board, (3.6) Filaments Drainage, (7.4)Structural Metal Edge, (7.5) Stainless Steel Cable



APPLICATION

The KLS-4520 structural edge, commonly referred to as intensive gravel boards, serves as a sophisticated landscape feature, enabling the establishment of deeper planting areas with media depths ranging from 10 to 18 inches. Upon request, these units can be customized with various sizes and paint colors. Moreover, they are suitable for use along the outer edges of green roofs. For tailored solutions that best suit your project, please reach out to Diadem.

SPECIFICATION

KLS edge profiles feature an L-shaped design crafted from high-grade aluminum, offering vertical separation between patio areas and lush vegetation or enclosing the perimeter of an exposed green roof. These profiles are self-supporting and do not necessitate membrane penetration.



TECHNICAL DATA

Profile Length: (feet)	4-6
Thickness: (Mil)	75-125
Height: (inch)	10-18
Weight: (lbs/lf)	4-5
Width: (inch)	8-12
Material: (Grade Al)	5052
Color Option: (RAL)	On Demand
Installation Standard: (hr/piece)	0.15
Material requirement: (piece/piece)	1.05

Reviewed: 2021-05-13 16:21:34



DIADEM USA, Inc.
8795 SW Tualatin Sherwood Rd #1005, Tualatin, OR 97062
info@diademusa.com • www.diademusa.com



Green Up the Roof!