

CascaDIA-80

310207

Modular green roof system with excellent water retention capacity.

KEY FEATURES

- High rainwater retention capacity — 8.83 oz/sqft
- Instant Green — fully precultivated modules provide immediate result
- Simplicity of Design — The Modules delivers the main green roof parts — drainage, growing-media and plants
- Easy handling and installation — Less than 40lbs/Tray, planted
- Durable and high impact-resistant material (HIPS) — Increased longevity
- Easy to fit - based on the different sides lenght, it is easy to fill out areas

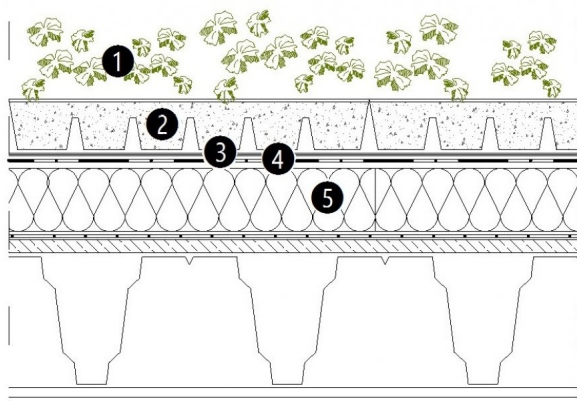
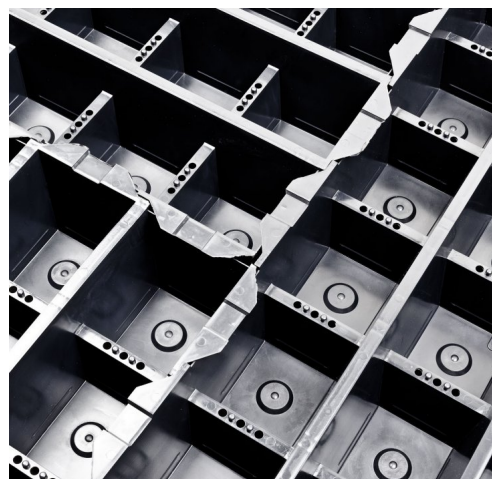

(1)Vegetation, (2)Modular Tray, (3)VLF 300 Mechanical Protection Layer, (4)Root resistant Waterproofing Membrane,(5)Roof construction

APPLICATION

Trays are typically a good fit for flat or slightly sloped roofs with a smaller area, or roofs with limited access, mainly on residential buildings. Diadem offers the flexibility of selecting either preplanting their modules off-site, which offers instant green, or assembling on-site which offers more flexibility to schedule installation.

SPECIFICATION

The CascaDIA-80 green roof modular system offers an excellent water retention capacity beyond the common advantages of the modular green roof systems. The outstanding features are the easy handling (~40lbs/tray), high water storage facility (8.84 oz/SF), and the high degree of diffusion capability.

TECHNICAL DATA

| | |
|------------------------------------|----------|
| Water flow rate: (gal/min/lf) | 13.53 |
| Tray / 100 sqf: (pcs) | 42.66 |
| Water retention capacity: (oz/sqf) | 8.83 |
| Height: (inch) | 3-1/8 |
| Net Width: (inch) | 14 13/16 |
| Net Length: (inch) | 22 5/16 |

Reviewed: 2008-06-19 13:25:34



DIADEM USA, Inc.
8795 SW Tualatin Sherwood Rd #1005, Tualatin, OR 97062
info@diademusa.com • www.diademusa.com



Green Up the Roof!