

VLU-300

320416

Needle-punched fabric for protection of the roof membrane and retaining storm water.

KEY FEATURES

- Resistant to both acidic and basic substances and environments.
- Withstands heavy point loading.
- Excellent permeability.
- Easy to cut.

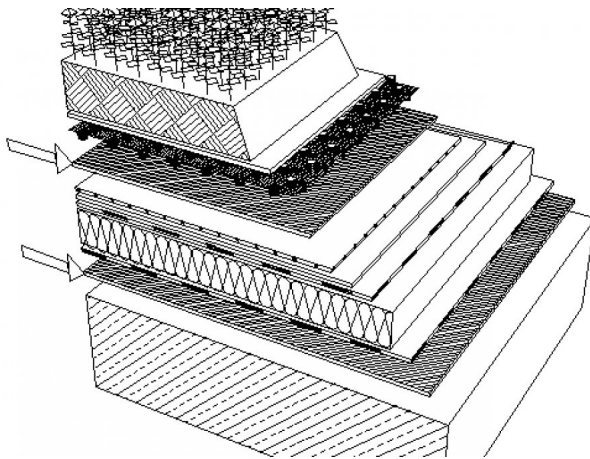

APPLICATION

The main functions of VLU geotextiles are mechanical protection of the waterproof membrane, and retaining a small portion of storm water runoff.

SPECIFICATION

TECHNICAL DATA

Puncture D4833: (N)	110
Tensile strength D4632: (lbs)	205
Water flow rate: (gpm/sqf)	110
Apparent opening size: (AOS^3)	80 US Std Sieve (0.18mm)
Roll width: (ft)	6-1/4
Roll length: (ft)	360
Roll area: (sqf)	2,250
Weight: (oz/sy)	8.0
Material requirement: (sqf/sqf)	1.15
Installation standard: (hr/sqf)	0.007
Robustness class: (GRK)	2

Reviewed: 2015-07-03 11:47:41



DIADEM USA, Inc.
8795 SW Tualatin Sherwood Rd #1005, Tualatin, OR 97062
info@diademusa.com • www.diademusa.com



Green Up the Roof!