

GF-1000

Skid layer for paved roofdecks

340120

KEY FEATURES

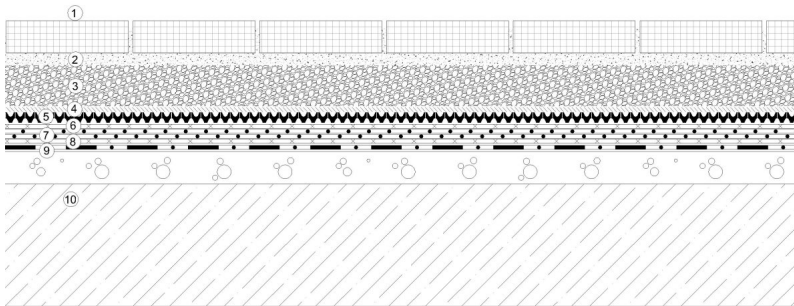
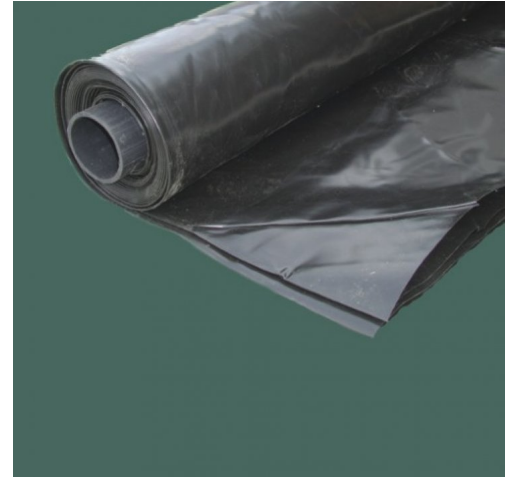

(1)Concrete slab, (2)Sand bedding, (3)Blinding layer, (4)VLF filter layer, (5)DiaMassive-25, (6)VLU mechanical protection layer,(7)GF-1000 skid membrane 2 layers,(8)VLU mechanical protection layer, (9)Root resistant waterproofing membrane, (10)Roof construction

APPLICATION

GF-1000 is recommended to install at paved roof areas of any kind from terraces to parking decks.

SPECIFICATION

Sliding layer made of polyethylene with high load bearing capacity to be installed in order to avoid damages caused due to slipping of roof layers on roofs suitable for vehicle traffic. Material thickness: 1 mm; roll size: 6 1/2 x 328 ft; surface weight: 3 oz/ft²; colour: black; material: polyethylene.



TECHNICAL DATA

Tear Resistance: (lbs/inch)	856.5
Elongation at Break: (%)	800
Tensile Strength at Break: (Psi)	4351.13
Elongation at Yield: (%)	10
Tensile Strength at Yield: (Psi)	2755.72
Density: (ounces / gallon)	125.5
Length: (ft)	328
Width: (inch)	78-3/4
Thickness: (Mil)	40
Carbon black content: (%)	2.0-3.0
Material:	HD Polyethylene

Reviewed: 2014-09-24 11:29:22



DIADEM USA, Inc.
8795 SW Tualatin Sherwood Rd #1005, Tualatin, OR 97062
info@diademusa.com • www.diademusa.com



Green Up the Roof!