

DRS-Light Handrail System

DRS-Light handrail system for Terraces and Exit Paths.

#710501



Manual

■ Green up the roof!



Application:

The main applications of the systems are where handrails are necessary - such as securing terraces or exit ways/working paths -, and penetrating the roof structure is not allowed, but aesthetics are preferred.

Installation instructions:

- Prior to installing the railings, place a minimum 2 inches deep bedding of 5/8" minus washed crushed stone on top of the heavy duty drainage board in the areas where the railings will be installed. Laying drainage boards underneath the bedding layer could be beneficial for proper drainage. Spread and consolidate the bedding as necessary to form a level base for the curbing.
- After the bedding has been approved install the railing systems as follows place the units on the roof, following the design plans.
- Attach the container units to every railing, and fix the railing units to each other and to the façade at the ends.
- Fine tune and adjust the handrail line and place the ballast items if necessary. Connect components of the system with the fasteners provided by the manufacturer. Fit exposed connections accurately together to form tight joints. For all connections with Diadem fittings, each set screw is to be tightened to 29 foot pounds (39 Nm) of torque.
- Set handrails accurately in position, with alignment and elevation measured from established lines and levels.

Installation Tools:

Compact bedding with a 200-300 lb. landscape roller or hand held compactor. Use a #6 hex key, also known as an Allen key or wrench, to install the bolts required for the assembly of the components.

Installation Photos:

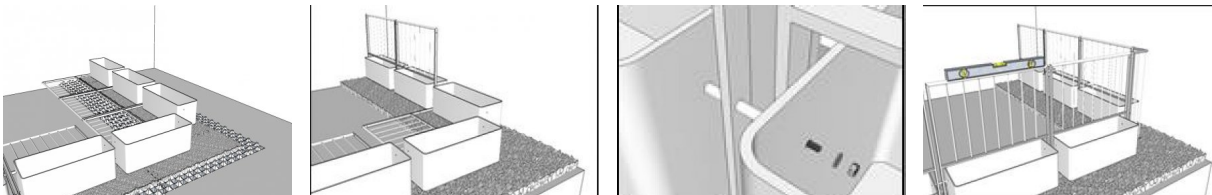

Reviewed: 2017-02-03 22:03:05

DIADEM USA, Inc.

8795 SW Tualatin Sherwood Rd #1005, Tualatin, OR 97062
Email: info@diademusa.com; Web: www.diademusa.com